

## CURVED SCREEN PROJECTION

**F**or the annual SemiCon Show 2006 in Singapore a curved screen projection was required to accentuate the booth of a local participant. The booth was specially designed around a central, large curved-screen application.

The screen itself consisted of a wooden construction which was painted plain white, attached in a slight angle at the back-wall just underneath the ceiling.

As it turned out the large screen became a challenge: Because of technical difficulties, the projector could not be mounted, as planned, inside the light column, but outside. This reduced the distance and caused the imagesize to decrease, so that the large screen dimension appeared unproportional.

To solve this dilemma a short throw lens was used, creating a larger image on the screen. Unfortunately, the short throw lens created kind of a slight fisheye-effect, distorting the image additionally to its basic distortion caused by the curved, angled screen.

However, the Image Anyplace IA-100 was easily able to correct the distortion and perfectly fit the image to the shape of the screen. The distortion caused by the angle was neutralized as well as the curved shape and the bent lines (fisheye-effect) were straightened.

The presentation that was used for the show contained a lot of written data and technical drawings and thus required exact and undistorted projection.

Image Anyplace IA-100 did an excellent job in correcting the distortions and deliver smooth and noise-free image-quality. Another aspect worth to mention is that the system was literally running non-stop during the 3 days of the show, creating no heat-problem or any other compromise in quality and performance.

The eWarp designer software allowed an easy adjustment of the shape and the IA-100 took care of smooth image-flow, maintaining highest quality level. After the projector was installed, the set-up of the IA-100 and adjustment of the image-shape ready to run for the show was 15 minutes. This allowed the installers to focus on other aspects and served as a time-saving solution in a tightly scheduled set-up.

### TECHNICAL DATA:

- ▷ Screen-Size: 2.4 x 2.2m
- ▷ Projector: Sanyo PLC-XP56
- ▷ Lumens: 5000
- ▷ Lens: LNS-W32
- ▷ System: IA-100\_BEX

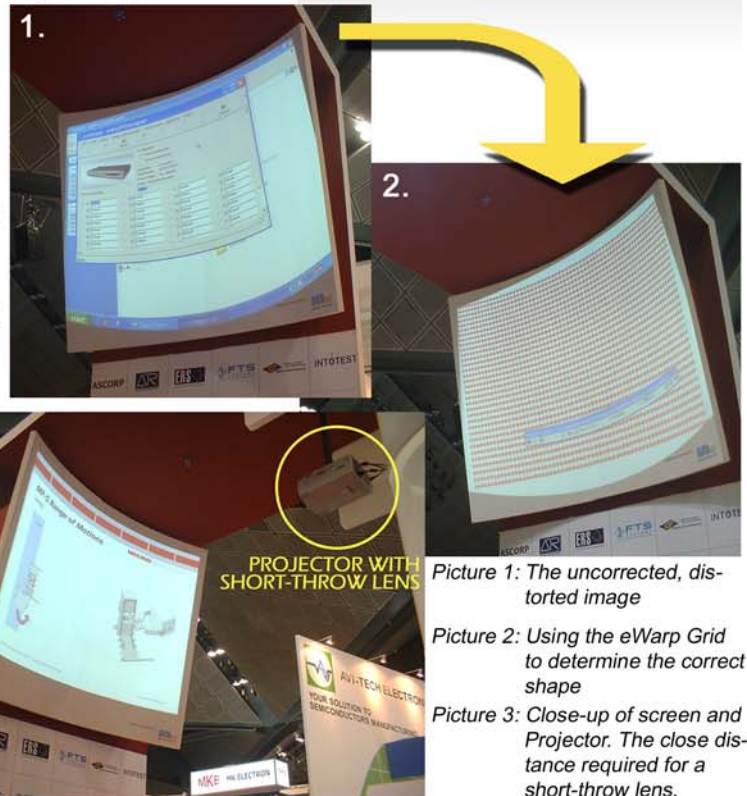

Picture 1: The uncorrected, distorted image  
Picture 2: Using the eWarp Grid to determine the correct shape  
Picture 3: Close-up of screen and Projector. The close distance required for a short-throw lens.

### The Booth



Pro-Wide Asia provided their customers with the only curved-screen projection at the SemiCon show 2006 in Singapore. With the large and unique application the booth was an eye-catcher for visitors and exhibitors alike. Generally, a dynamic display helps to deliver information successfully to customers and draws attention. As the trend in the AV industry proves, non-flat screen applications and creative designs are the future of projection and are the edge of display technology.

Pro-Wide Asia is proud to be part of this new movement...

